

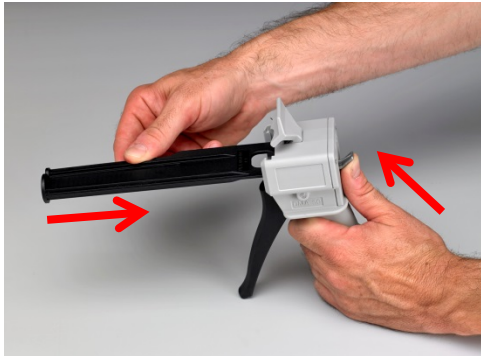

## Dispensing Gun Direction for 845™ Adhesive – 43 ml cartridge



1. Press the metal lever at the end of the dispensing gun. Insert the black plunger into the body of the gun.



2. Hold the metal lever and pull the black plunger forward.



3. Turn the white cap counterclockwise  $\frac{1}{4}$  turn and remove cap from the cartridge.



4. Clear any obstructions inside the nozzle openings with a probe. Place the white cap back on the cartridge and turn clockwise  $\frac{1}{4}$  turn.



5. Insert the Weld-On 845™ adhesive cartridge into the dispensing gun.



6. Press the gray lever down to lock the cartridge onto the dispensing gun.



## Dispensing Gun Direction for 845™ Adhesive – 43 ml cartridge



7. Turn the white cap counterclockwise  $\frac{1}{4}$  turn and remove cap from the cartridge.



8. Squeeze the black lever and dispense a small amount of adhesive making sure that both components flow freely from the cartridge nozzle.



9. Insert the mixing tip to the cartridge and turn clockwise  $\frac{1}{4}$  turn to lock the mixing tip onto the cartridge.

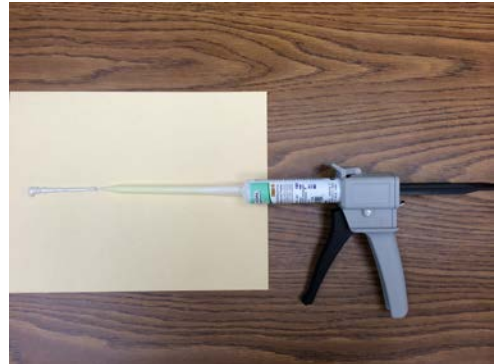

10. Squeeze the black lever and dispense approximately 1 to 2 inches to ensure both components of the adhesive are completely mixed before use.



11. The assembled dispensing gun is now ready for use.

*Note: the adhesive inside the mixing tip may cure if the tip is left on the cartridge for a prolonged duration without additional use. In this case, keep the mixing tip on the cartridge. When you are ready to dispense the adhesive again, replace the mixing tip. Dispense and discard 1 – 2 inches of the adhesive prior to use.*